

Galvanised steel / brass, robust and durable, for extremely high flow rates

One-hand quick disconnect couplings, one side sealing, that combine optimal flow rates (approx. 4 times as high as the popular standard coupling DN 7.2) with minimal coupling forces.

Suitable for all applications with an above-average air requirement and characterised by extreme conditions!

Operating pressure	Max. 16 bar
Temperature range	-20 °C to +100 °C
Flow rate (air)	3900 l/min
Material	Nickel-plated steel, nickel-plated brass
Sealant	NBR



410.43



410.53



410.65

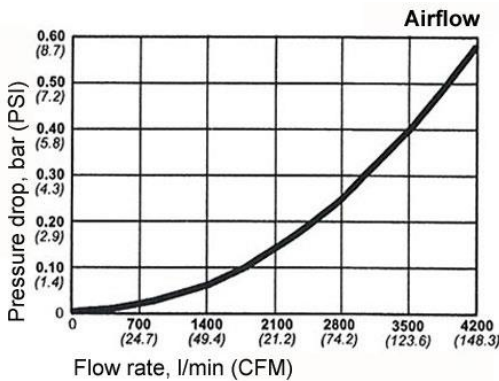

### Quick disconnect couplings DN 10, galvanised steel / brass, robust type, male

Art. No.	Ident No.	Connection	Length mm	a/f mm	Ø mm
410.42	107465	R 3/8 male	68.3	24	27.4
410.43	107466	R 1/2 male	70.8	24	27.4

### Quick disconnect couplings DN 10, galvanised steel / brass, robust type, female

Art. No.	Ident No.	Connection	Length mm	a/f mm	Ø mm
410.52	107467	G 3/8 female	62.8	24	27.4
410.53	107468	G 1/2 female	67.8	25	27.4

### Quick disconnect couplings DN 10, galvanised steel / brass, robust type, with hose stem

Art. No.	Ident No.	Connection	Length mm	a/f mm	Ø mm
410.64	107469	Stem, I.D. 10	77.3	24	27.4
410.65	107470	Stem, I.D. 13	75.8	24	27.4

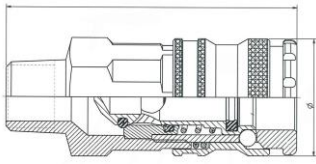

Male

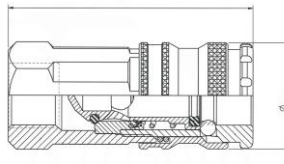

Female

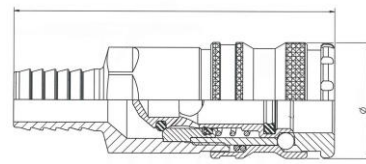

Hose connection

Stems for couplings DN 10, hardened, galvanised steel, robust type

Art. No.	Ident No.	Designation	a/f mm	Length mm	L1 mm	L2 mm	Ø mm	D mm
410.91	107471	Stem I.D. 10	-	45.5	21.3	21.0	10.4	17.0
410.92	107472	Stem I.D. 13	-	45.0	21.3	21.0	10.4	17.0

Plugs for couplings DN 10, hardened, galvanised steel, robust type, male

Art. No.	Ident No.	Designation	a/f mm	Length mm	L1 mm	L2 mm	Ø mm	D mm
410.93	107473	Plug R 3/8 male	17	41.0	21.3	11.4	10.4	15.1
410.94	107474	Plug R 1/2 male	22	47.5	21.3	15.0	10.4	15.1

Plugs for couplings DN 10, hardened, galvanised steel, robust type, female

Art. No.	Ident No.	Designation	a/f mm	Length mm	L1 mm	L2 mm	Ø mm	D mm
410.95	107475	Plug G 3/8 female	20	38.0	21.3	11.4	10.4	15.1
410.96	107476	Plug G 1/2 female	27	43.5	21.3	15.0	10.4	15.1



410.92



410.93



410.95

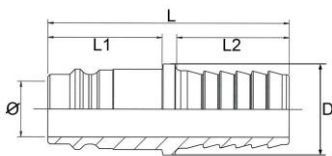

Stem

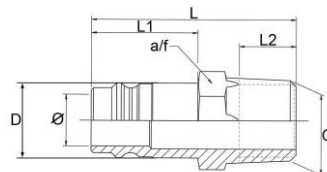

Plug male

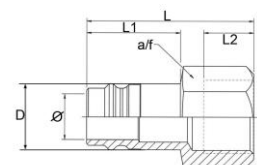

Plug female